

## LAMPIRAN

Koneksi pengujian mode GST

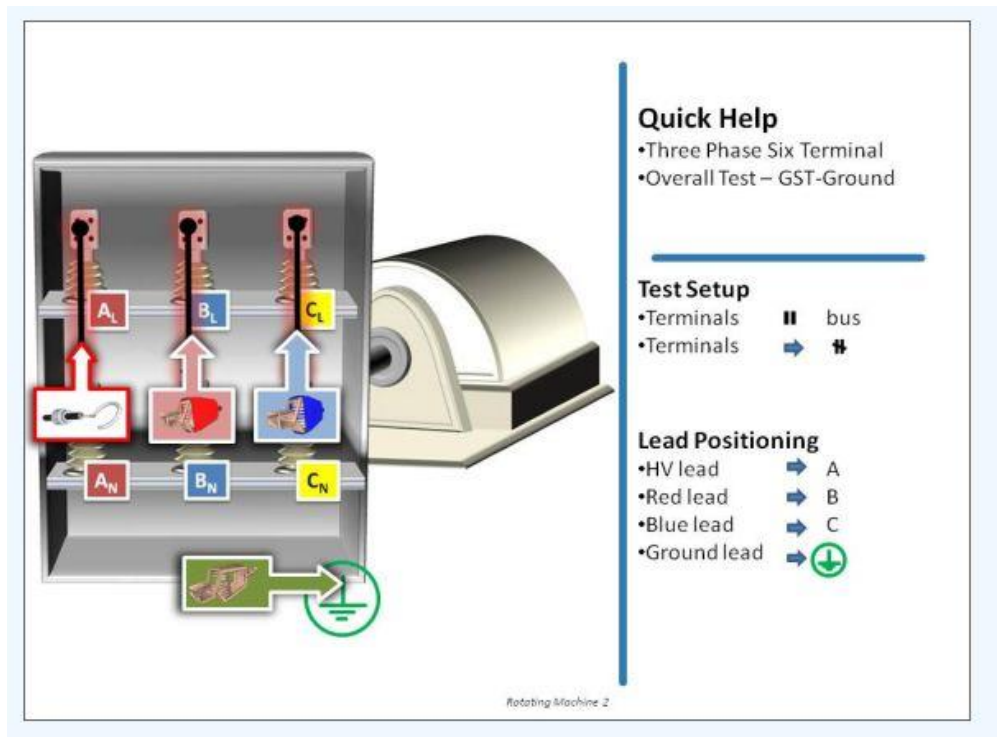

## Data Pengujian

# HD191-1-12\_RM



**Report Source** RotatingMachinery

**Session Test Date** 2/24/2018 3:26:26 PM

### Nameplate - Rotating Machinery

<b>Company</b>	PT Pembangunan Jawa Bali	<b>Serial Number</b>	HD191-1-12
<b>Location</b>	PLTU PACITAN	<b>Special ID</b>	GENERATOR #2
<b>Division</b>	ENGINEERING UPHT	<b>Semi-con coating</b>	
<b>Manufacturer</b>	DONGFANG ELECTRIC	<b>Volt Grading Applied</b>	
<b>Year Manufactured</b>	2008	<b>Global VPI</b>	
<b>Year in Service</b>	2008	<b>Res. Serial Number</b>	
<b>Year Rewound</b>		<b>HP/kW</b>	316000.000 Kilowatts
<b>Stator kV</b>	20	<b>Type</b>	
<b>Frequency Hz</b>	50	<b>Cooling</b>	Hydrogen and Water
<b>Machine</b>	Steam Turbine Generator	<b>Insulation Name</b>	
<b>Insulation Type</b>	Epoxy-Mica	<b>CCT Designation</b>	
<b>Configuration</b>	3-phase, 6 Terminals		
<b>kVa1</b>	371700.000	<b>H2 Pressure</b>	300 kPa
<b>kVa2</b>	*	<b>H2 Pressure</b>	*
<b>Sta. Amp1</b>	10732.000	<b>Power Factor</b>	0.85
<b>Sta. Amp2</b>	*		
<b>Type</b>	Cylindrical	<b>Amps</b>	2153.000
<b>Volts</b>	0	<b>Speed/rpm</b>	3000.000
<b>Poles</b>	2		

### Overall Tests

#	Energize	Gnd	UST	Test kV	AC Watts	RIV	mA	Watts	Cap(pF)	% PF Meas.	Tip Up	Ir Auto	Manual
1	Winding	Shaft		*	*	*	*	*	*	*	*		
2	A	B, C		2.000	*	*	618.977	117.610	196904.5	1.900	*		
3	A	B, C		3.999	*	*	618.771	118.551	196946.0	1.916	0.016		
4	A	B, C		5.999	*	*	618.741	119.035	197005.0	1.924	0.024		
5	A	B, C		8.002	*	*	618.845	121.355	197079.0	1.961	0.061		
6	A	B, C		10.042	*	*	619.704	134.943	197446.5	2.178	0.277		
7	B	C, A		1.999	*	*	620.061	124.339	197858.5	2.005	*		
8	B	C, A		4.000	*	*	621.119	124.638	197831.0	2.007	0.001		
9	B	C, A		6.001	*	*	622.732	126.327	197965.5	2.029	0.023		
10	B	C, A		8.002	*	*	622.367	129.333	198005.5	2.078	0.073		
11	B	C, A		10.069	*	*	624.350	144.239	198530.0	2.310	0.305		
12	C	A, B		1.999	*	*	619.080	119.522	197056.5	1.931	*		
13	C	A, B		3.999	*	*	620.435	120.246	197118.0	1.938	0.007		
14	C	A, B		5.999	*	*	620.385	121.352	197196.5	1.956	0.025		
15	C	A, B		8.002	*	*	620.715	123.201	197263.0	1.985	0.054		
16	C	A, B		10.006	*	*	621.787	138.213	197642.5	2.223	0.292		